

A wide-angle photograph of a golf course. In the background, a large clubhouse with a dark roof is partially obscured by a dense line of tall pine trees. The middle ground features a green fairway with several sand traps and a small pond. In the foreground, a large, dark shadow of a tree is cast across the grass. The sky is a clear, bright blue.

PittmanPoe
& ASSOCIATES, INC.

World-Renowned

Land Planners,

Par Excellence.

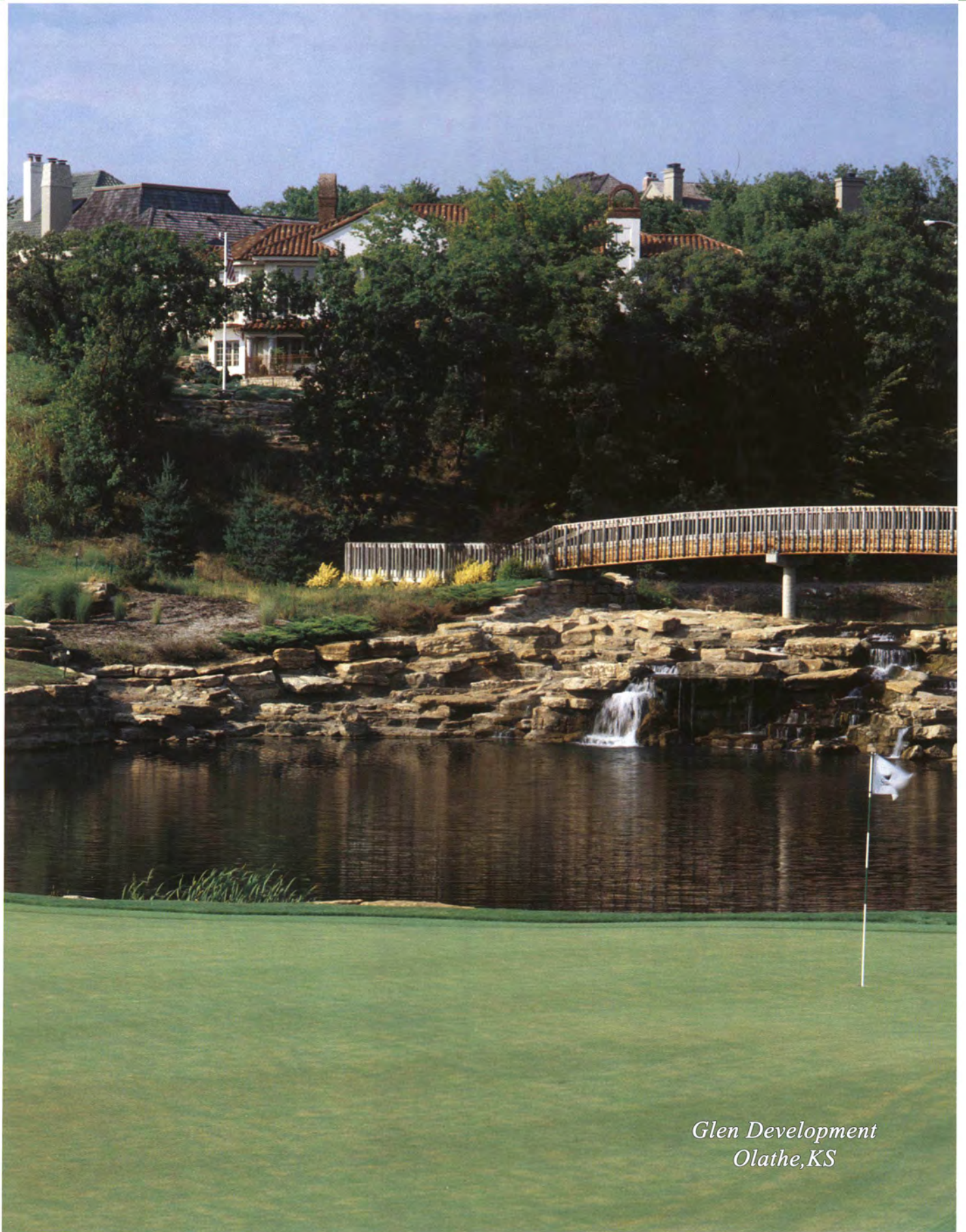

*Glen Development
Olathe, KS*

The foundation for the design philosophy of Pittman Poe is based on the belief that the importance of the earth and the environment cannot be underestimated. Being sensitive to the land and its topography and habitats, Pittman Poe evaluates the property being impacted in order to create economic and aesthetic enhancement. The objective is to leave the land better than it was found with the developer maximizing his investment.

With the increase of regulations and filing requirements, the firm's experience with various regulatory agencies, planning commissions and city councils means you can be confident your project will be handled in the most professional manner to produce the highest and best land uses.

In short, if a project deals with the land, Pittman Poe has the education, knowledge and talent to do the job right. The first time. On time. On budget.



Bailey Ranch, Owasso, OK



'Bland's experience, attention to detail, and understanding of complex municipal, state and federal land planning requirements has made major contributions to many of our CCA projects. His flexibility and creative problem solving make him the best in the business. You get full value for your dollar when you have Bland Pittman on your development team.'

George Blonsky, CLUBCORP REALTY

*Bland Pittman.
A Biographical Sketch.*

“We want to do what’s right for the land, what’s right for the project and what’s right for the client. If we go into it with that in mind, we always end up with something beautiful.”

Bland Pittman

Bland started Poe & Associates Planning, Inc. after moving to Tulsa in 1973. In 1984, the company name was changed to Pittman Poe & Associates, Inc. and Bland became Senior Partner and President of the firm. He has been the significant factor in the planning of over 50 successful golf communities throughout the U.S. and overseas. Bland has also been a planning consultant on many mixed-use projects, subdivisions, public recreation facilities, shopping centers, public and private golf courses and resort communities.

Bland has received numerous national awards in design competition and is listed in Who’s Who in Texas and Who’s Who in the Southwest. Active in charitable and civic affairs, Bland is a member of the American Planning Association, Urban Land Institute, National Association of Industrial and Office Parks, and the National Golf Foundation.



Holes No. 16 & 17 at Bailey Ranch

Pittman Poe & Associates, Inc.

Arkansas

- ▲ ■ Circle Farms, Fayetteville
- ▲ Little Rock AFB Golf Course, Little Rock
- ▲ Springdale Country Club, Springdale

Arizona

- ▲ ■ Arizona Highlands, Prescott
- Dessert Highlands, Scottsdale
- ▼ Eloy East, Eloy
- ▼ Oro Valley, Tucson
- Pinnacle Peak North, Scottsdale
- The Boulders, Care Free
- Troon North, Scottsdale
- Tucson Golf Club, Tucson
- Tubac, South of Tucson
- ▲ ■ Vista Laguana, Lake Havasu

California

- Bear Creek, Temecula
- Goose Neck, Lake Tahoe
- Gunner Ranch, Fresno
- Marbella Golf & Country Club, Dana Point
- ★ Marina Bay, San Francisco
- ▲ ■ Santa Barbara Ranch, Santa Barbara
- Spanish Hills, Camareo

Colorado

- Adams Rib Ranch, Eagle Vail
- Aspen Glen Club, Carbondale
- Castle Pines, Castle Rock
- ▼ Snow Creek, Steamboat Springs CCA

Florida

- ★ Claugton Island, Miami
- ● Errol Golf Community, Orlando CCA
- Naples Bath & Tennis Club

Georgia

- Cherokee Trace, Atlanta

Hawaii

- ● Kauai Ranch, Kauai
- ● Kohala Ranch, Big Island CCA
- ● Maui International

Kansas

- Shadow Glen @ Cedar Creek, Olatha
- Willow Bend, Wichita

Louisiana

- ▲ ■ Bedico Creek, Mandeville

Michigan

- ● Forest Dunes, Roscommon
- ● Shanty Creek, Bellaire

Minnesota

- The Wilds, Prier Lake

Mississippi

- Annandale Golf Club, Jackson
- Shell Landing, Biloxi

Missouri

- ▲ Lebanon Country Club
- Olde Kinderhook, Camdenton
- St. Albano, St. Louis
- ▲ ■ Wicked Stick, St. Roberts

Montana

- ▲ ■ The Montana Valley Club, White Fish

New Mexico

- Chama Ranch, Chama

New York

- St. Andrews, White Plains

North Carolina

- ■ Centennial Course NO. 8
- Pinehurst Golf Institute CCA
- ▲ Pinehurst NO. 9 CCA
- Pinewild Golf Community CCA
- ▲ Pinewild Golf Training Center CCA

Oklahoma

- ★ Aspen Creek, Broken Arrow
- ▲ Altus AFB Golf Course, Altus
- ▲ Bailey Ranch, Owasso
- ▲ Battle Creek, Broken Arrow
- ▼ Brighton Oaks, Tulsa
- ▲ Cedar Ridge, Practice Facility, BA
- ▼ Chelsea Pond, Tulsa
- ▼ Cooper Ranch, Owasso
- ▼ Cross Timbers, Sapulpa
- ▼ Dover Pond, Owasso
- ▲ Flint Ridge, Jay
- ▲ Fort Sill Golf Course, Lawton
- Golf Club of Oklahoma, Broken Arrow
- ★ Greenway Business Park, Broken Arrow
- ▼ Holland Lakes, Tulsa
- ▼ Hunters Hills, Tulsa
- ▼ Hunters Pointe, Tulsa
- ▲ Idabel Country Club, Idabel
- ★ Kimberly Clark Landscape, Bixby
- ▲ Lawton Country Club, Lawton
- ▲ Peoria Ridge Golf Club, Miami
- ▲ Pheasant Run, Enid
- ▼ Preston Lakes, Owasso
- ★ Remington Park Track, Oklahoma City
- River Oaks, Bixby
- Rose Creek, Edmond
- ▼ Saddleback, Broken Arrow
- ▼ Scissortail Ridge, Owasso
- Shangri La, Grand Lake
- ▲ Shawnee Country Club, Shawnee
- ▼ Signal Hill, Tulsa
- ★ Smith Farms, Owasso
- ▲ Southern Hills (Tee Renovation US Open)
- ▼ Stanford, Elms, Tulsa
- ▼ Stonewood Crossing, Broken Arrow
- ★ Stonewood Hills "Bass Pro," BA
- The Coves, Grand Lake
- ▼ The Greens @ Cedar Ridge
- ▼ The Lakes @ Indian Springs, BA
- ▲ The Woods, Coweta

Ohio

- Quail Hollow, Cleveland CCA

Pennsylvania

- Bent Creek Golf Community, Lancaster

Tennessee

- ▲ ■ Gettysvue Polo – Golf & C.C., Knoxville

Texas

- ▲ ● Barton Creek Resort, Austin CCA
- Buffalo Creek Golf Club, Rochwall
- ★ Chandlers Landing, Rochwall
- ▼ El Rancho Vista, Denton CCA
- Gleneagles Golf Community, Plano
- Horseshoe Bay Resort, Marble Falls
- ★ Las Colinas, Irving
- ▲ Lost River Country Club, Waco
- Mira Vista Club, Ft. Worth
- ▲ Pecan Valley Golf Course, Ft. Worth

Utah

- ▲ ● Round Valley, Park City

International

- ▲ ● Anguilla (The Ocean Club)
- ▲ ● Castelas, France CCA
- ▲ ● Climbing Clouds, China
- Coral Springs, Jamaica
- Elgin, France CCA
- ▲ ● Twin Seas Resort, Bahamas
- Marlboro Heights, India
- ▲ ■ Mount Edgcombe, South Africa CCA
- ▲ ● Rose Hall, Jamaica
- Rum Pointe, Belize
- Sizzano, Italy
- ▲ ● Son Sastre, Mallorca
- ▲ ● The Bahamas Club, Bahamas
- ▲ ● Zembali Resort, South Africa

Legend

- | | |
|---|-------------------------|
| ▲ | Golf Course Design |
| ▲ | Golf Course Routing |
| ● | Resort Community |
| ▼ | Residential Subdivision |
| ■ | Golf Community |
| | Master Plan |
| ★ | Mixed-Use Development |

Aspen Glen

Private country club living near Aspen

Aspen Glen Development Team:

Owner/Developer

The Aspen Glen Company

Golf Course Architect

Jack Nicklaus/Jack Nicklaus II
Co-Design Signature Course

Land Planning

Pittman Poe & Associates, Inc.

Golf Course Routing

Pittman Poe & Associates, Inc.

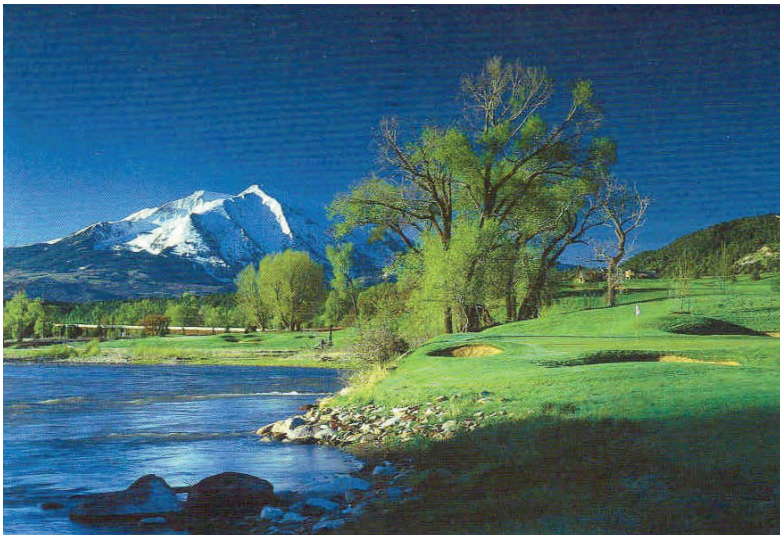
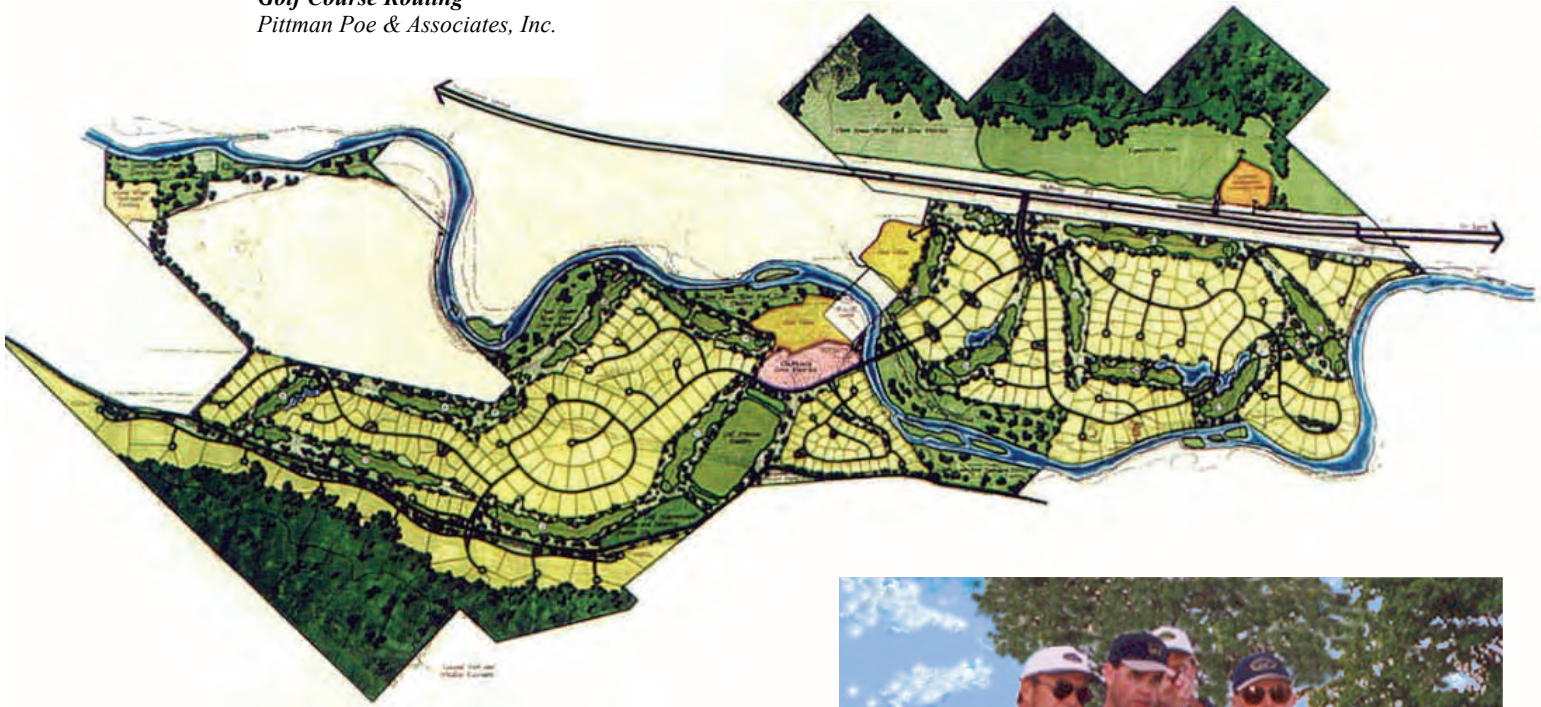

Hunter Pittman (center) and Jack Nicklaus discuss course layout.

Pittman Poe & Associates, Inc.

1709 W. Granger Street, Broken Arrow, Ok 74012

Phone: (918) 355-8552 Fax: (918) 355-8393

email: office@pittmanpoe.com website: www.pittmanpoe.com

*Gettysvue
Polo Golf & Country Club
Knoxville, Tennessee*



Gettysvue Development Team:

Developer
Partners & Associates, Inc.

Land Planning
Pittman Poe & Associates, Inc.

Golf Course Architect
*Bland Pittman,
Pittman Poe & Associates, Inc.*

Engineering
Mauldin Parnell, Inc.



Pittman Poe & Associates, Inc.

1709 W. Granger Street, Broken Arrow, Ok 74012
Phone: (918) 355-8552 Fax: (918) 355-8393
email: office@pittmanpoe.com website: www.pittmanpoe.com

Shell Landing

Golf Community Development

Gautier, Mississippi

Land Planning
Pittman Poe & Associates, Inc.

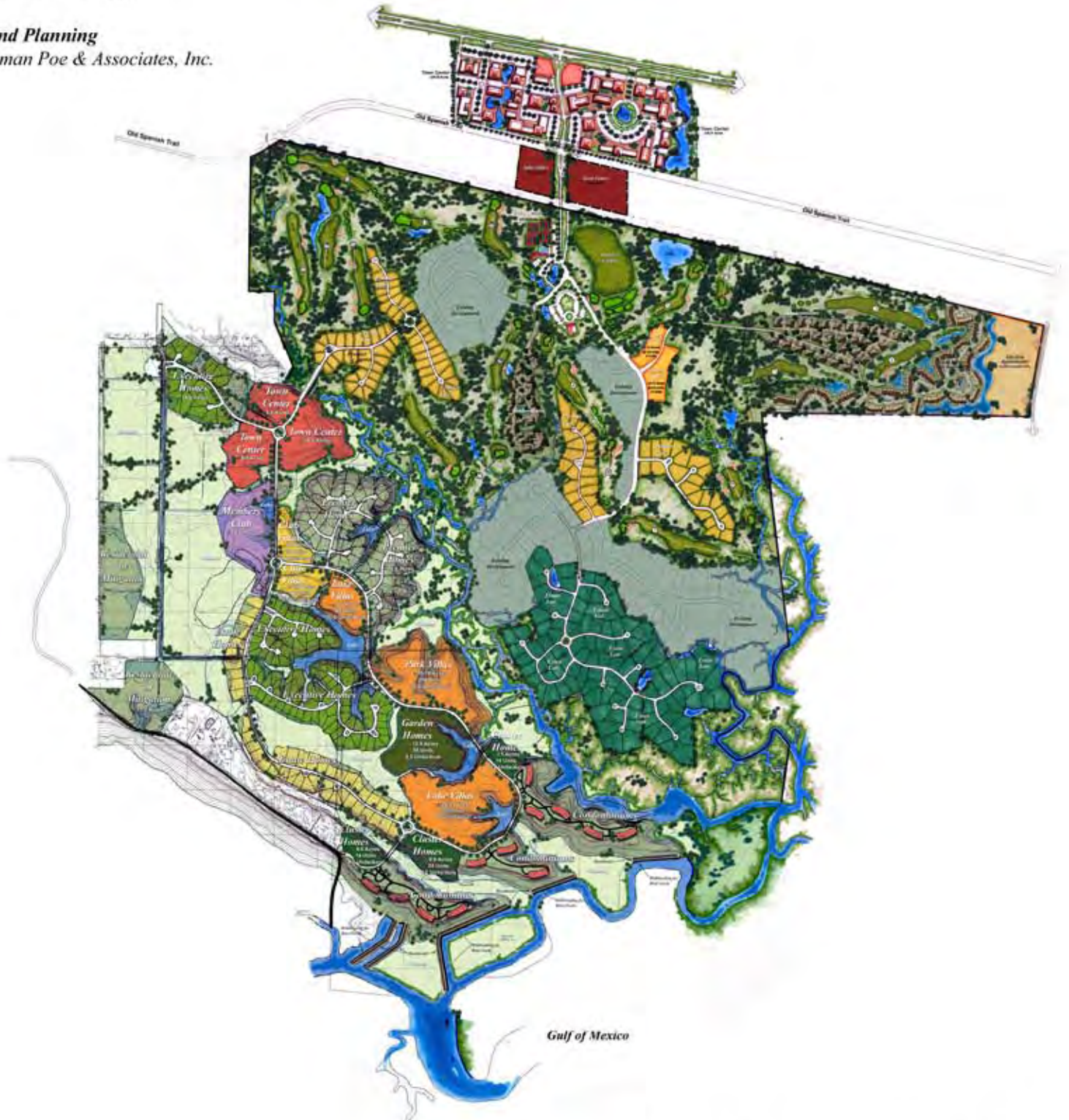

Pittman Poe & Associates, Inc.

1709 West Granger Street, Broken Arrow, Oklahoma 74012
Phone: (918) 355-8552 Fax: (918) 355-8393
email: office@pittmanpoe.com website: www.pittmanpoe.com

Battle Creek

Community Development



Data Summary

Total Project Area: ±786.5 Acres (Gross)
±717.8 Acres (Net)

Total Max. Allowable Dwelling Units: 2779 DU

Total Floor Area:
• Office: 825,798 Sq. Ft.
• Commercial: 1,040,736 Sq. Ft.
• Hotel/Conference Area: 225,000 Sq. Ft.

Golf Course Area: 175.7 Acres

Project Density: 3.5 DU/Acre

Land Planning

Pitman Poe & Associates, Inc.

Golf Course Architect

Bland Pitman, Pitman Poe & Associates, Inc.



Brooks Pitman
Clubhouse Architect



Pitman Poe
& ASSOCIATES, INC.

*Shiloh
Battle Creek Golf Community
Broken Arrow, Oklahoma*

Shiloh Development Team:

Owner/Developer
Buford Williams

Golf Course Architect
Bland Pittman

Land Planning
Pittman Poe & Associates, Inc.



Pittman Poe & Associates, Inc.

1709 W. Granger Street, Broken Arrow, Ok 74012
Phone: (918) 355-8552 Fax: (918) 355-8393
email: office@pittmanpoe.com website: www.pittmanpoe.com

Bailey Ranch Golf Community Owasso, Oklahoma

Bailey Ranch Development Team:

Owner/Developer
The Larkin Bailey Trust

Golf Course Architect
Bland Pittman
Pittman Poe & Associates, Inc.

Land Planning & Master Planning
Pittman Poe & Associates, Inc.

Clubhouse Architect
Brooks Pittman
Pittman Design Architecture



Pittman Poe & Associates, Inc.

1709 W. Granger Street, Broken Arrow, Ok 74012
Phone: (918) 355-8552 Fax: (918) 355-8393
email: office@pittmanpoe.com website: www.pittmanpoe.com

*Bailey Ranch
Golf Community
Owasso, Oklahoma*

Bailey Ranch Development Team:

Owner/Developer
The Larkin Bailey Trust

Golf Course Architect
Bland Pittman
Pittman Poe & Associates, Inc.

Land Planning & Master Planning
Pittman Poe & Associates, Inc.

Clubhouse Architect
Brooks Pittman
Pittman Design Architecture



Pittman Poe & Associates, Inc.

1709 W. Granger Street, Broken Arrow, Ok 74012
Phone: (918) 355-8552 Fax: (918) 355-8393
email: office@pittmanpoe.com website: www.pittmanpoe.com

Peoria Ridge Golf Club
Miami, Oklahoma



Peoria Ridge Development Team:

Developer
 Peoria Tribe of Indians of Oklahoma

Land Planning
 Pittman Poe & Associates, Inc.

Golf Course Architect
 Bland Pittman,
 Pittman Poe & Associates, Inc.



The Golf Digest Review-April 2001

Peoria Ridge Golf Club

Unusual for Oklahoma. Seems like Illinois farmland. Hilly and ryegrass/buffalo grass rough. Very enjoyable and one of the best "small town" golf courses around... Course has a surprising amount of elevation change and uses it well to achieve very good design variety along with its varying hole lengths. Greens were quite good—firm and relatively fast. 11th hole is a dramatic 201-yard downhill par 3 overlooking a lake behind the green—one of the best holes on the course... A good feeling course that left you wanting to play again when you were done... I was pleasantly surprised by this course. There is a very small clubhouse (temporary), parking lot, etc. as you drive in so the first impression is that the course will probably be an average one. However, when I got to the first tee, I could tell I was going to change my opinion. There is a great practice area. The tees, fairways and greens were great considering the course opened this past March. Another pleasant surprise was the GPS on all the carts at no extra charge to the patron. The designer of the course did a fantastic job in making each hole special and a pleasure to play... U-3 Bermuda fairways and L-93 Bent greens are in excellent condition. Water comes into play on some holes. Five sets of tees make it playable for all skill levels.

Phase One Development

Pittman Poe & Associates, Inc.

1709 W. Granger Street, Broken Arrow, Ok 74012
 Phone: (918) 355-8552 Fax: (918) 355-8393
 email: office@pittmanpoe.com website: www.pittmanpoe.com

*Mira Vista
Country Club
Fort Worth, Texas*

Master Plan

Mira Vista Development Team:

Developer
Jerry L. Thomas Investments, Inc.

Owner
Metropolitan Financial Savings

Golf Course Architect
Tom Weiskopf and Jay Morrish

Land Planning/Site Planning
Pittman Poe & Associates, Inc.

Clubhouse Architect
William Zmistowski Associates

Landscape Architecture
Cormier & Associates



Mira Vista Club Complex



Detailed Land Plan



Pittman Poe & Associates, Inc.

1709 W. Granger Street, Broken Arrow, Ok 74012
 Phone: (918) 355-8552 Fax: (918) 355-8393
 email: office@pittmanpoe.com website: www.pittmanpoe.com

Bahama Club

Golf Resort Community
Bahamas

Bahama Club Design Team:

Land Planning

Pittman Poe & Associates, Inc.

Golf Course Architect

Pittman Poe & Associates, Inc.
in association with Raymond Floyd

Golf Course Routing

Pittman Poe & Associates, Inc.



Pittman Poe & Associates, Inc.

1709 West Granger Street, Broken Arrow, Oklahoma 74012

Phone: (918) 355-8552 Fax: (918) 355-8393

email: office@pittmanpoe.com website: www.pittmanpoe.com



Las Colinas

A 3500 Acre Master Planned
Community of Balanced
Land Use. Office
Industrial
Distribution
Hotels
Residential
Apartments
Townhouses
Recreation



Castle Pines

Home of the International Tournament



Master Planning:
Pittman Poe & Associates, Inc.

Golf Course Architect:
Jack Nicklaus



Pittman Poe & Associates, Inc.

1709 West Granger Street, Broken Arrow, Oklahoma 74012
Phone: (918) 355-8552 Fax: (918) 355-8393
email: office@pittmanpoe.com website: www.pittmanpoe.com

Bedico Creek Golf Community Development

Madisonville, Louisiana

Land Planning & Golf Course Design
Pittman Poe & Associates, Inc.



Pittman Poe & Associates, Inc.

1709 West Granger Street, Broken Arrow, Oklahoma 74012

Phone: (918) 355-8552 Fax: (918) 355-8393

email: office@pittmanpoe.com website: www.pittmanpoe.com

Pinewild
Country Club of Pinehurst
 Pinehurst, North Carolina

Pinewild Development Team:

Owner/Developer
 Club Corp

Project Manager
 George Blonsky

Golf Course Architect
 Gary Player

Golf Course Routing
 Pittman Poe & Associates, Inc.

Master Planning & Land Planning
 Pittman Poe & Associates, Inc.

Pinewild Golf Practice Facility
Golf Architecture
 Pittman Poe & Associates, Inc.



Pinewild Golf Practice Facility



Pittman Poe & Associates, Inc.

1709 W. Granger Street, Broken Arrow, Ok 74012
 Phone: (918) 355-8552 Fax: (918) 355-8393
 email: office@pittmanpoe.com website: www.pittmanpoe.com

“Personal attention to detail is the name of the game when you are working toward the final success of any project. Over the years, Bland Pittman has exemplified this by his personal commitment and appearance on the job. Bland Pittman is definitely a ‘people person,’ and because of his experience, is very comfortable dealing with the environmental and political concerns any project must face today.”

Tom Weiskopf

Hole No. 6 at Aspen Glen with Mt. Sopris in the background.



“Co-designing a golf course like The Bahama Club with Bland is both exciting and fun. What makes it even more pleasant is that he’s also the project land planner.”

Raymond Floyd

Introducing Pittman Poe & Associates. After many successful years and a client list direct from the golf community’s who’s who, this company should need no introduction.

Pittman Poe’s world-wide client base consists of private land developers and government agencies involved in the planning of:

- Golf, Resort and Residential Communities
- Urban Centers
- Recreation Areas and Sports Complexes
- Commercial Centers
- Industrial Parks

The firm provides services that include:

- Land and Project Feasibility Analysis
- Site Selection
- Pre-Planning, Zoning and Master Planning
- Golf Course and Landscape Design
- Documents and Specifications
- On-Site Supervision



Pittman Poe & Associates, Inc. Golf & Resort Communities

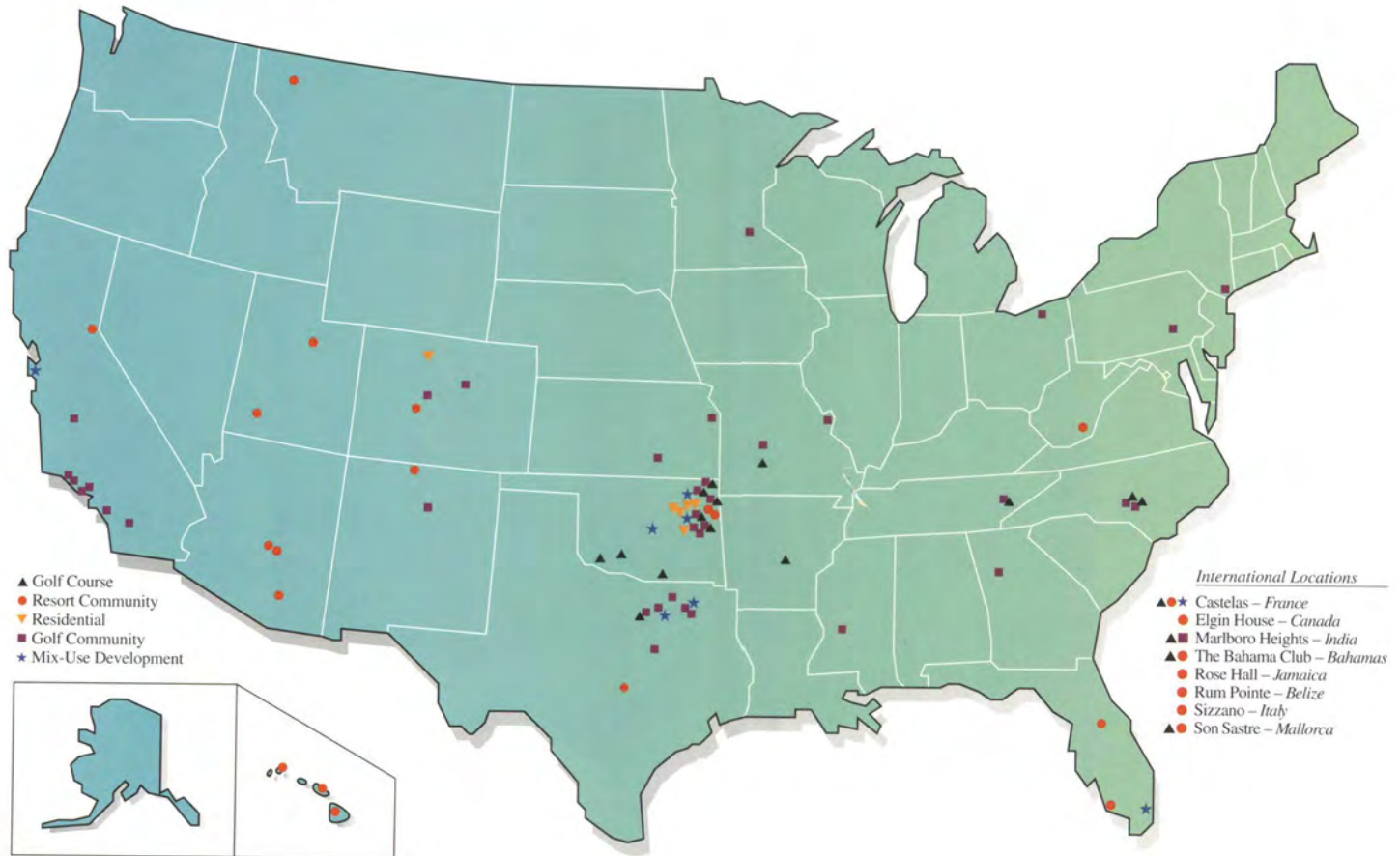

PittmanPoe
 & ASSOCIATES, INC.

1709 W. Granger St.
 Broken Arrow, OK 74012

Phone: 918/355-8552
 Fax: 918/355-8393

web: www.pittmanpoe.com

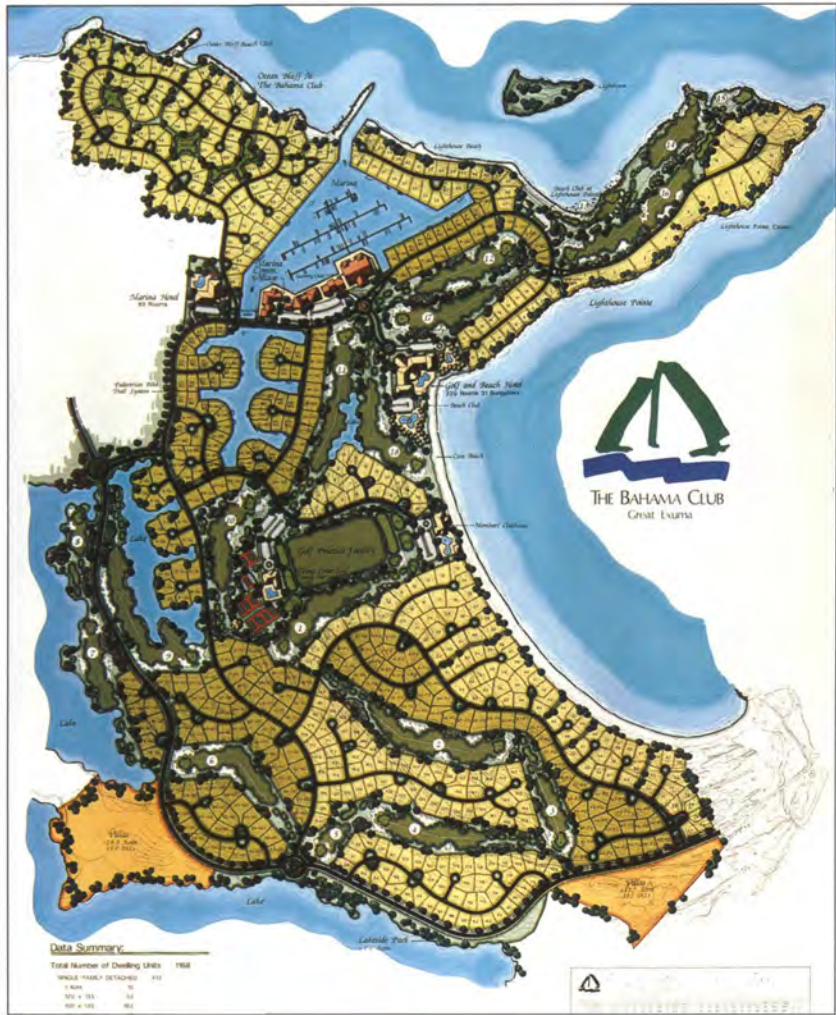

The Bahama Club, Bahamas



Pinewild Golf Practice Facility, Pinehurst, NC